

Facilities Master Plan

Task Force Meeting #4

January 6, 2022



Agenda

- Welcome and Check-In

- Elementary Input and Feedback from December 21 meeting
- District Demographic Data–BIG Picture

- District Projected Data–Rob from RSP
 - Current data
 - Projected data

- Update on Secondary Data Collection–Susan from OPN
- Next Steps



CRCSD STRATEGIC PLAN

FIVE YEAR STRATEGIC PLAN SYSTEM INDICATORS:

EQUITY	PROFICIENCY	GRADUATION RATE
By June 2022, CRCSD will reduce gaps in reading and math across all student demographic groups (ELL, IEP, race) by 20%. From 18-19 22.8% → 2022 30.2% average gap	By June 22 2022, at least 80% of students will score proficient or advanced on ISASP. From 18-19 64.5% → 2022 80% average proficiency	By June 2022, CRCSD will increase graduation rate by 10%. From 2017 4 year 83.5% → 2022 93.5% 5 year 86.4% → 2022 96.4%

FOCUS AREAS:

CULTURE	STUDENT LEARNING	WORKFORCE	SYSTEMS AND RESOURCES
<p>PURPOSE: Provide a safe, supportive, collaborative culture in which diversity of every learner is valued and embraced</p> <p>MEASURES:</p> <ul style="list-style-type: none"> Intercultural Development Inventory (IDI) Continuum Data High Reliability Schools (HRS) Survey Data Every Student Succeeds Act (ESSA) – Conditions for Learning Survey Data Family Engagement Data <p>STRATEGIES:</p> <ul style="list-style-type: none"> Diversity, Equity, and Inclusion Plan Intercultural Development Plan High Reliability Schools (HRS) Level 1 Implementation and School Improvement Plans (SIP) Family Engagement Strategic Plan Magnet Schools and innovative Programs Plan 	<p>PURPOSE: Ensure high quality instruction which fosters and inspires academic, social, and emotional learning and growth to meet the needs of every student.</p> <p>MEASURES:</p> <ul style="list-style-type: none"> Formative Assessment System for Teachers (FAST) – Benchmark and Growth Future Ready Pathway Course Enrollment Data Profile of a Graduate Rubric Measures I ready <p>STRATEGIES:</p> <ul style="list-style-type: none"> Academic Road Map Strategic Plan (HRS Levels 1-4) Profile of a Graduate Implementation Plan School Improvement Plans New Art and Science of Teaching Instructional Framework Aligned to Individual Professional Development Plans Digital Literacy and Technology Plan Magnet Schools and Innovative Programs Plan 	<p>PURPOSE: Engage and empower a talented and diverse workforce who supports Every Learner. Future Ready.</p> <p>MEASURES:</p> <ul style="list-style-type: none"> Staff Engagement Survey Workforce Demographics Professional Growth Dashboard Employee Retention <p>STRATEGIES:</p> <ul style="list-style-type: none"> Diversity, Equity, and Inclusion Plan Workforce Recruitment, On-Boarding, and Succession Plan Employee Relations Plan Benefit Programs Plan HR Systems and Plan 	<p>PURPOSE: Maximize operational systems and prioritize resources based on student needs while maintaining the financial health of the district.</p> <p>MEASURES:</p> <ul style="list-style-type: none"> Systems Completion Milestones In-home Internet Access School Safety and Security Drills Audit Results Communications Engagement Data <p>STRATEGIES:</p> <ul style="list-style-type: none"> Technology Strategic Plan System Upgrade and Integration for Human Resources and Facilities Master Plan (Phase I and Phase II) (Planned Science III) Transportation Strategic Plan Nutritious and Healthy Meals Implementation Plan Communications Strategic Plan

Our Vision: Every Learner. Future Ready. Our Mission: To ensure all learners experience a rigorous and personalized learning experience so they have a plan, a pathway and a passion for their future.



Theory of Action

SMART Goals

ELEMENTARY DATA

- Notes and Feedback
- From December 21
- Demographic Data
- Projection Data–RSP



Executive Summary Committee Recommendation



10 Newly Constructed Elementary Schools (K-5)

Note: Depends on the Community Hub Outcome for Arthur, Harrison, and Wright



3 Renovated Elementary Schools

Note: Depends on the Community Hub Outcome for Arthur, Harrison, and Wright



8 Elementary Schools Phased Out

Tiers

Elementary schools are separated by Tier purely based on the percentage in the Facility Condition Index (Page 83).

In order to create flexibility where the elementary site Re-Investment opportunities occur, a tiered system has been applied. The tiering system is created as a guide to help determine which projects should be completed. The determination of which site is in a tier could be modified to fit Academic, Culture, or Economic (ACE) variables.

The "Tier" system created is based on the Facility Condition Index (FCI) per building. The FCI is based on the square footage of each building and the total amount of money needed to repair the building to the standards of the State of Iowa. Although a school may be ranked higher in the "Facility Cost Index" (Page 89), a different school may be in a higher tier due to its size and total needs.

Tiers are a guideline, they are flexible to adjust for the Community Hub conversations.

Tier 1

Elementary School	Tier Rank	Facility Cost Index	Future High School Feeder
Coolidge	1	1	Jefferson
Arthur	1	4	Washington
Jackson	1	13	Kennedy

Tier 2

Elementary School	Tier Rank	Facility Cost Index	Future High School Feeder
Harrison	2	3	Jefferson
Cleveland	2	6	Jefferson
Pierce	2	7	Kennedy
Erskine	2	11	Washington
Wright	2	12	Washington

Tier 3

Elementary School	Tier Rank	Facility Cost Index	Future High School Feeder
Hoover	3	14	Jefferson
Johnson	3	16	Washington
Grant	3	20	Washington
Viola Gibson	3	21	Kennedy
Hiawatha	3	22	Kennedy

Elementary Sites Unknown Future

Elementary School	Tier Rank	Facility Cost Index	Future High School Feeder
Kenwood	2	2	Washington
Taylor	2	5	Jefferson
Grant Wood	2	8	Washington
Garfield	1	9	Washington
Van Buren	1	30	Jefferson
Nixon	1	35	Kennedy
Truman	2	37	Jefferson
Puk	-	18	-
Madison	2	19	Kennedy
Monroe	-	23	-

Plan Details:

- Thirteen Elementary Schools
- Twelve are Four section 600 capacity
- One is a Three section 450 capacity
- Potentially Ten are new schools
- Note: depends on the outcome for Arthur, Harrison, and Wright
- Three are renovated schools
- Note: depends on the outcome for Arthur, Harrison, and Wright
- Several sites might utilize significant portions of the historical architecture
- The criteria used to Invest or Eliminate a site was based on having 70% or greater committee response during the discussion about each site

Tiers Schedule

Tier 1 Projects	Tier 2 Projects	Tier 3 Projects
2020	2023	2028
2021	2024	2029
2022	2025	2030
	2026	2031
	2027	2032
		2033

The first Elementary School project would begin in the year 2020, with a new Elementary School project occurring each year thereafter.

Maximum of 13 years to complete Elementary School Re-investment.

Items that influence the timeline:

- Secure an Advanced Vision for Education (SAVE) extension becoming available July 2020
- Available SAVE funds for District use
- Discretion by Legislature may impact the amount of SAVE funds district receives
- Site Choice by the Tier Levels
- Other considerations might happen to influence a cross over in schools that would be considered before others.
- Community Hub discussions

District Demographic Data Review



Cedar Rapids Enrollment and Demographic History

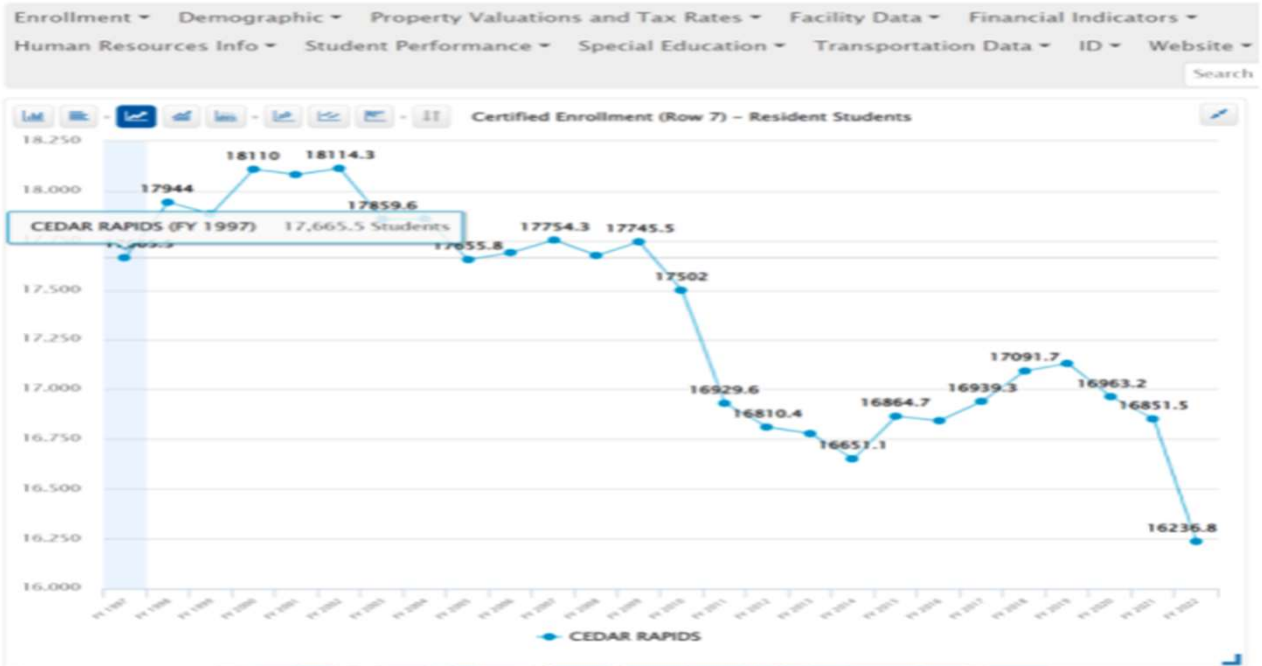

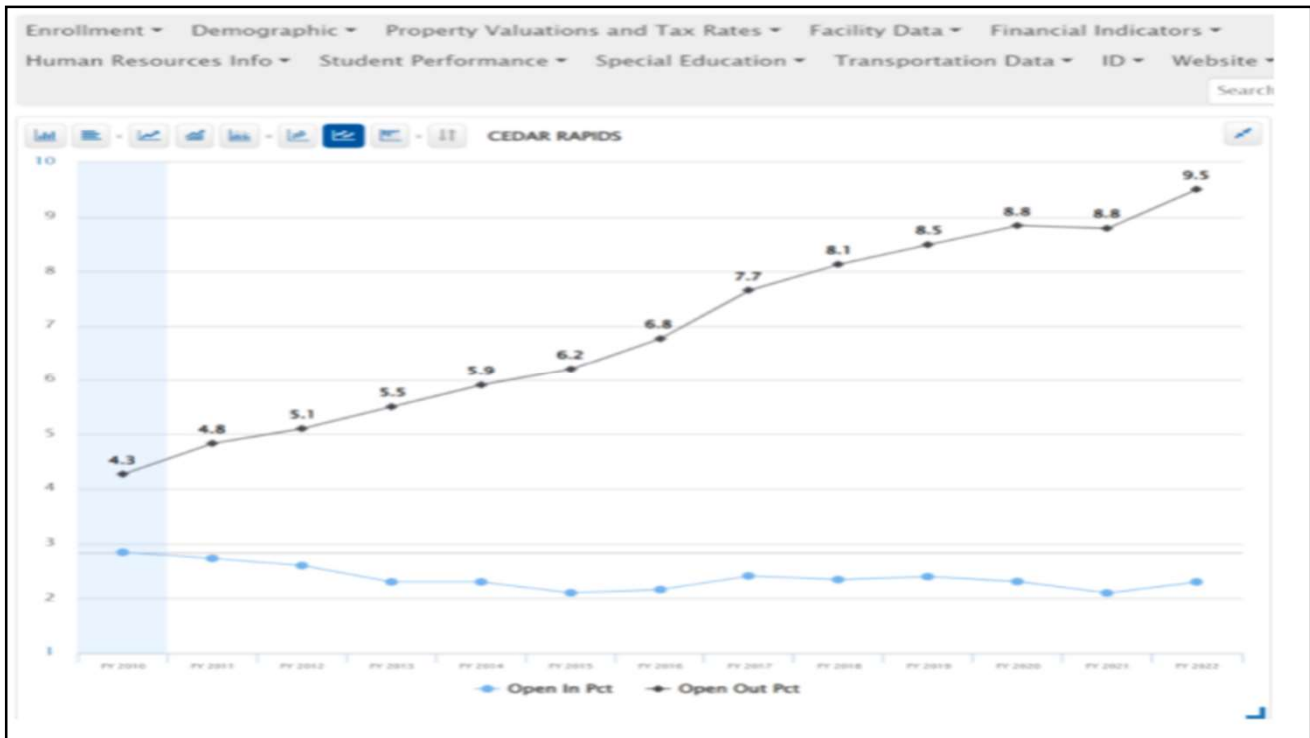

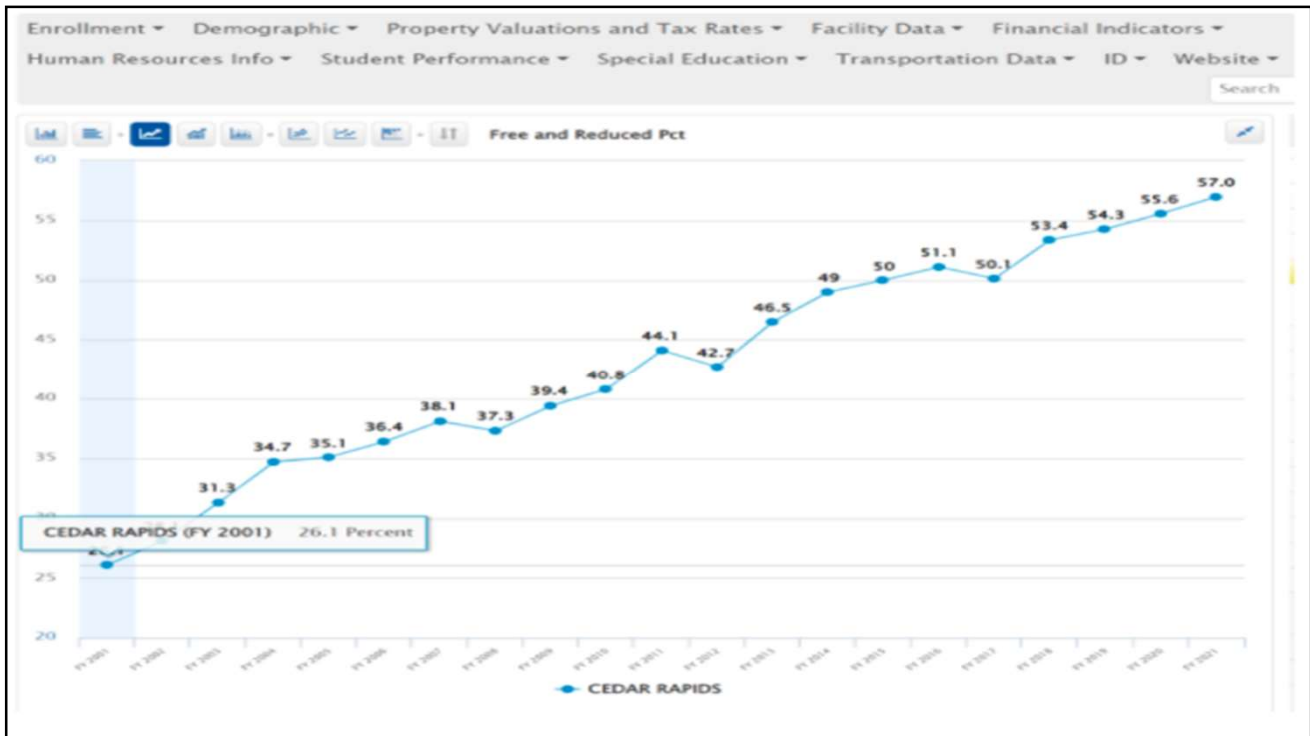

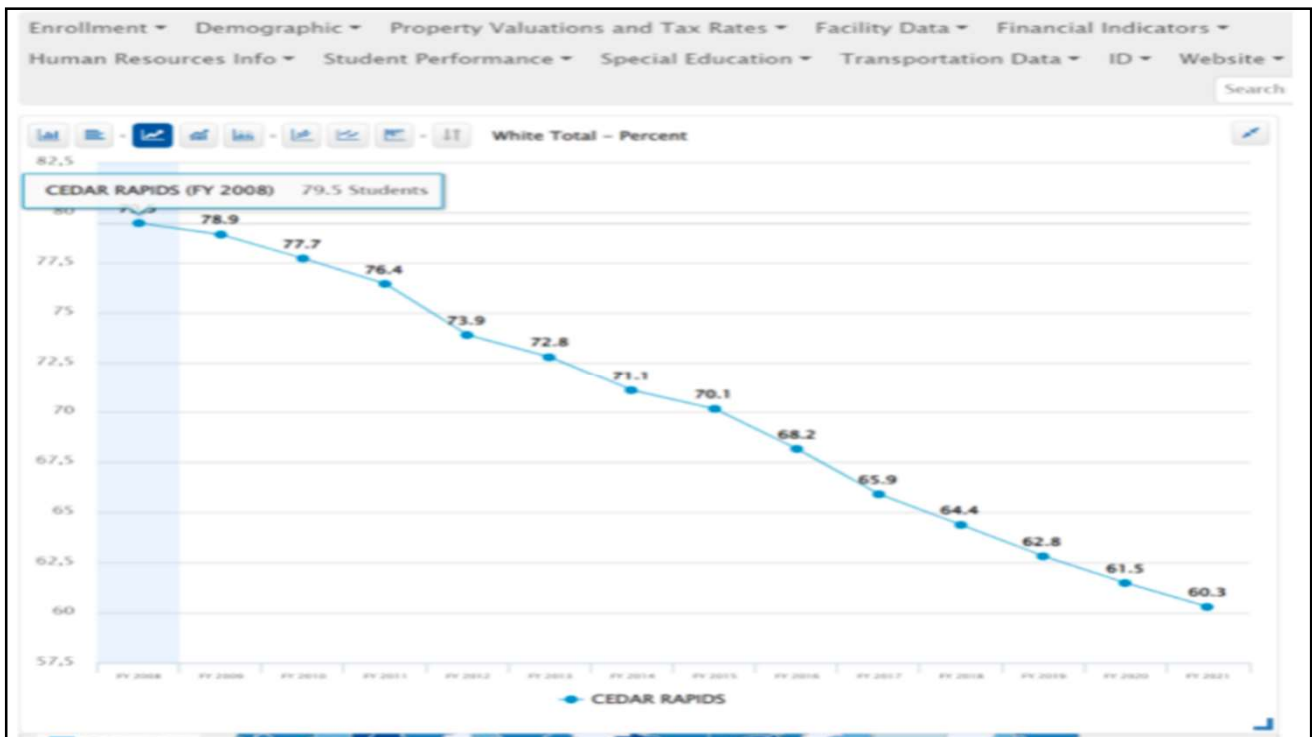

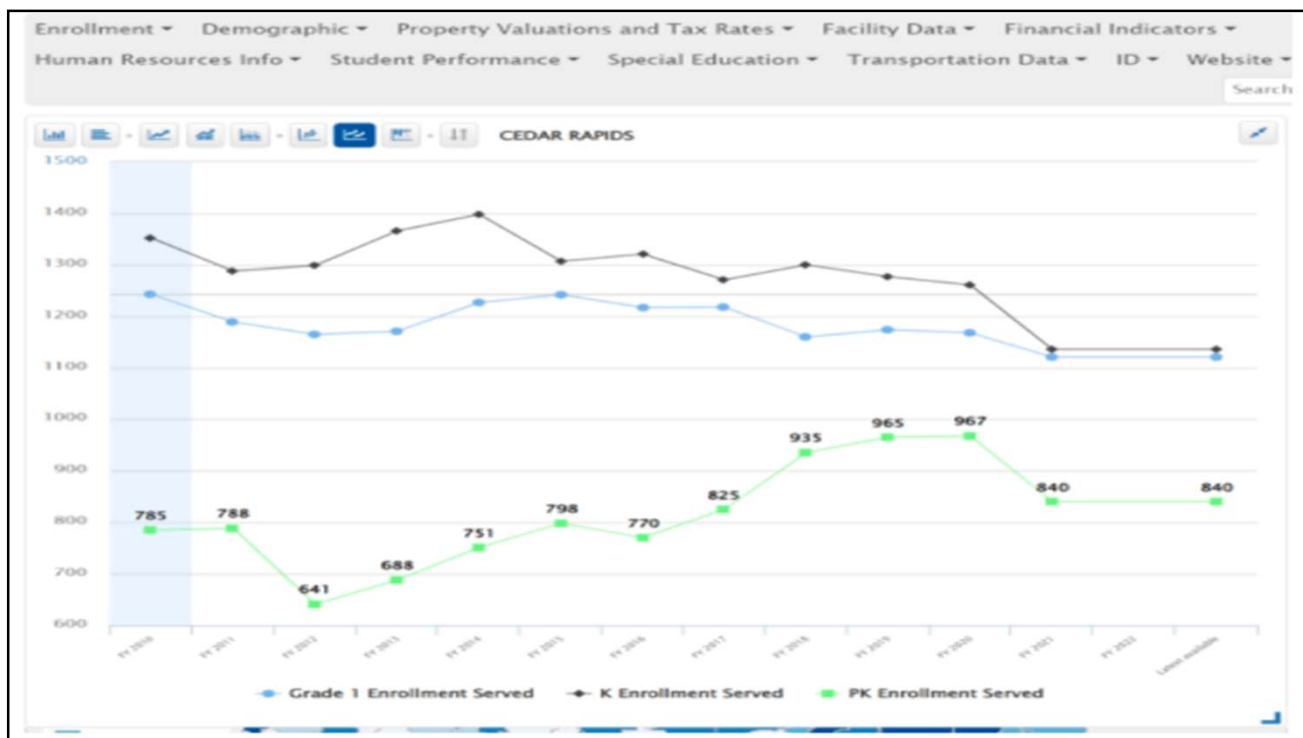

District Data–RSP Data

SECONDARY DATA UPDATE

- OPN
- Assessment Data
- Listening Sessions



FACILITY ASSESSMENT PROCESS



TRANSPARENT ENGAGEMENT



SECONDARY SCHOOL PROCESS

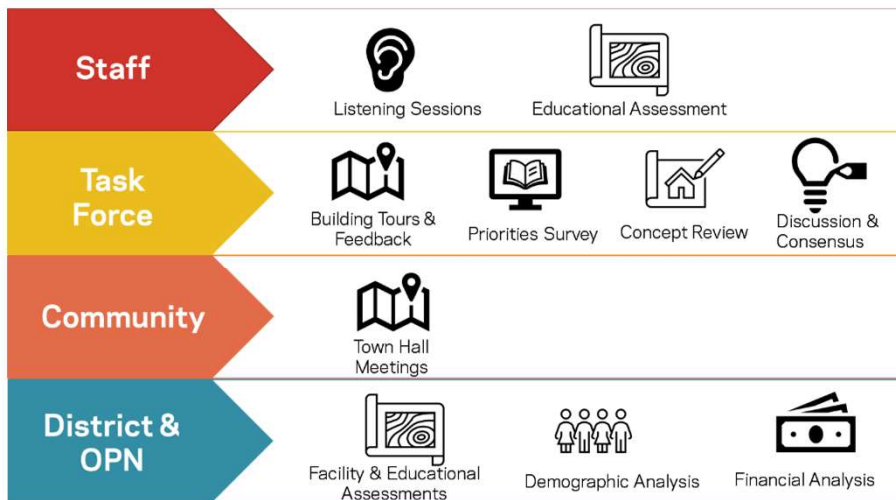

MIDDLE & HIGH SCHOOLS

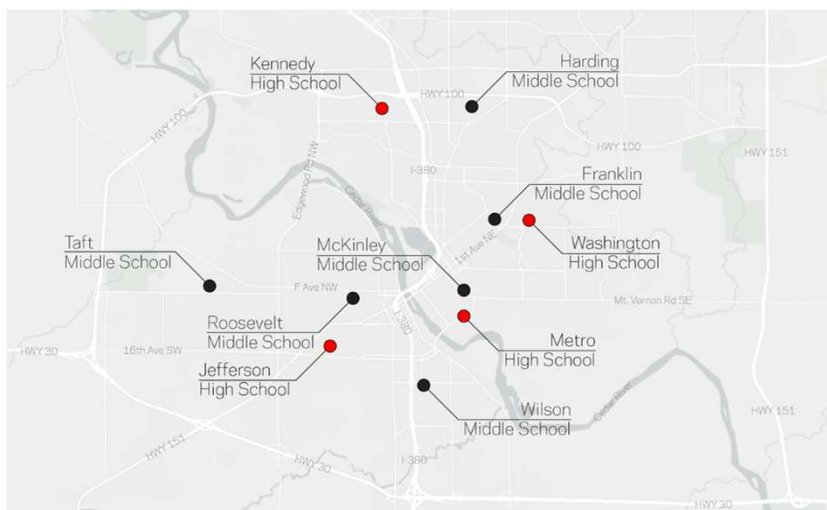

TAFT MIDDLE SCHOOL

- 111,440 GSF
- 750 NSF AVG CLASSROOM



Site Deficiencies

1. Parking longitudinal slope in excess of 2.0%
2. ADA parking space not accompanied by an access aisle
3. Ramp slope is not compliant
4. A-H: Non-accessible exit / entrance

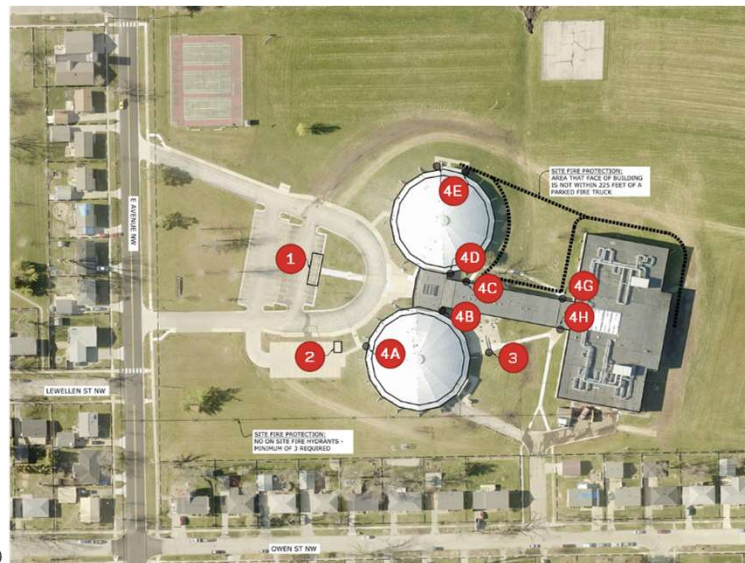

Physical Assessment

Floor Assessment / Taft Middle School

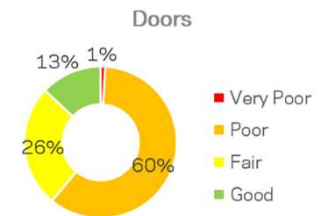
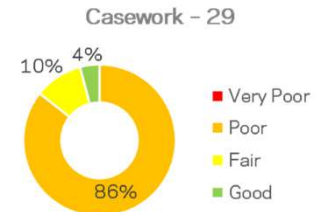
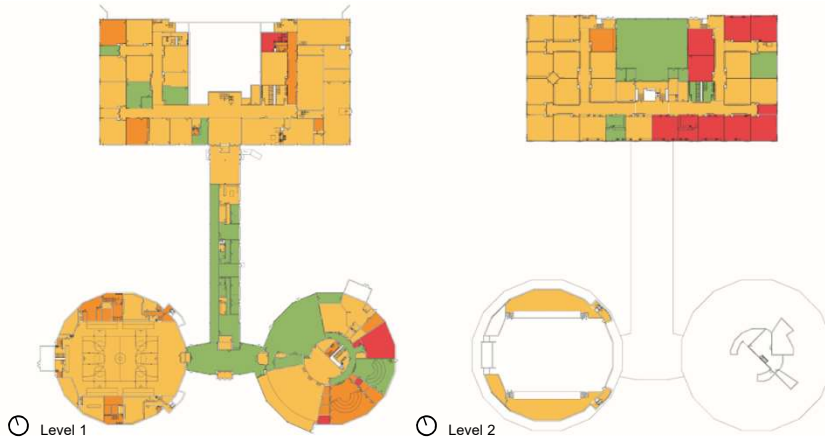

Physical Assessment

Ceiling Assessment / Taft Middle School

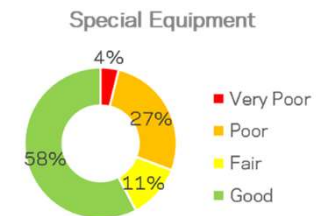
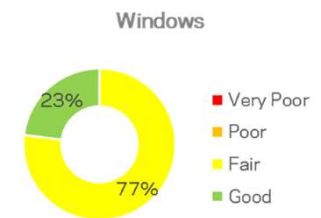
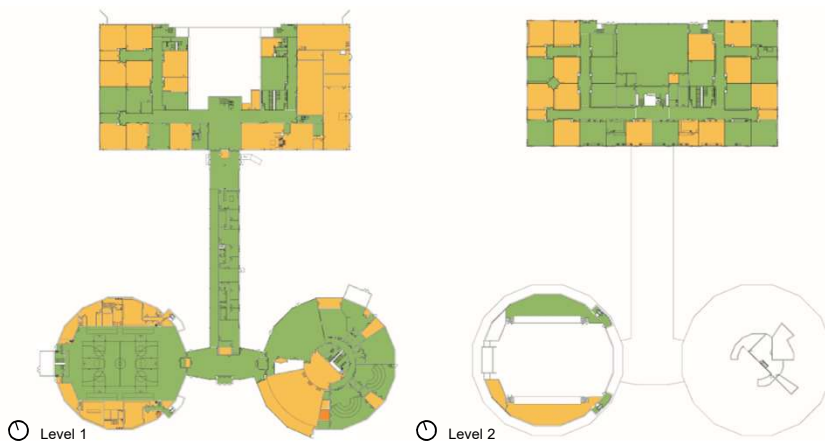

Physical Assessment

ADA Code Compliance / Taft Middle School

1. Non-compliant fixtures and stalls in restrooms
2. Non-ADA casework and sinks
3. Non-compliant stairs / guard rails, no handrails
4. No ADA accessible seating
5. Food Service:
 1. Serving equipment cannot maintain proper temperatures
 2. Undersized equipment
 3. Equipment beyond life expectancy

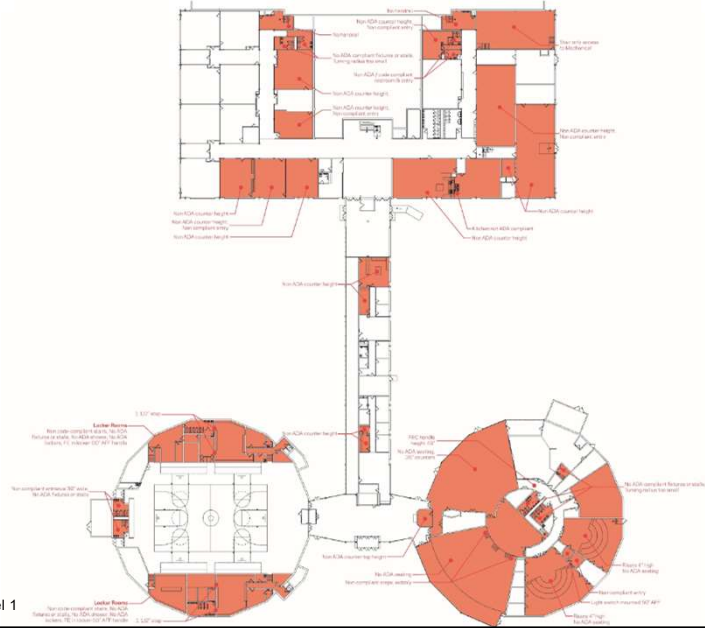

Physical Assessment

ADA Code Compliance / Taft Middle School

1. Non-compliant fixtures and stalls in restrooms
2. Non-ADA casework and sinks
3. Non-compliant stairs / guard rails, no handrails
4. No ADA accessible seating
5. Food Service:
 1. Serving equipment cannot maintain proper temperatures
 2. Undersized equipment
 3. Equipment beyond life expectancy

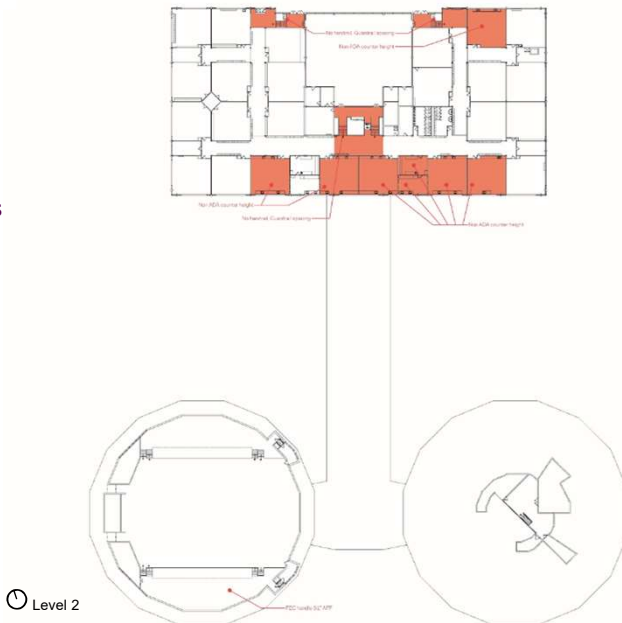

Physical Assessment

Mechanical / Taft Middle School

- Terminal Heat Pumps
- Unit Ventilators
- Ventilation
- HVAC Distribution (piping & ductwork)
- HVAC Controls
- Plumbing Systems
- Fire Suppression

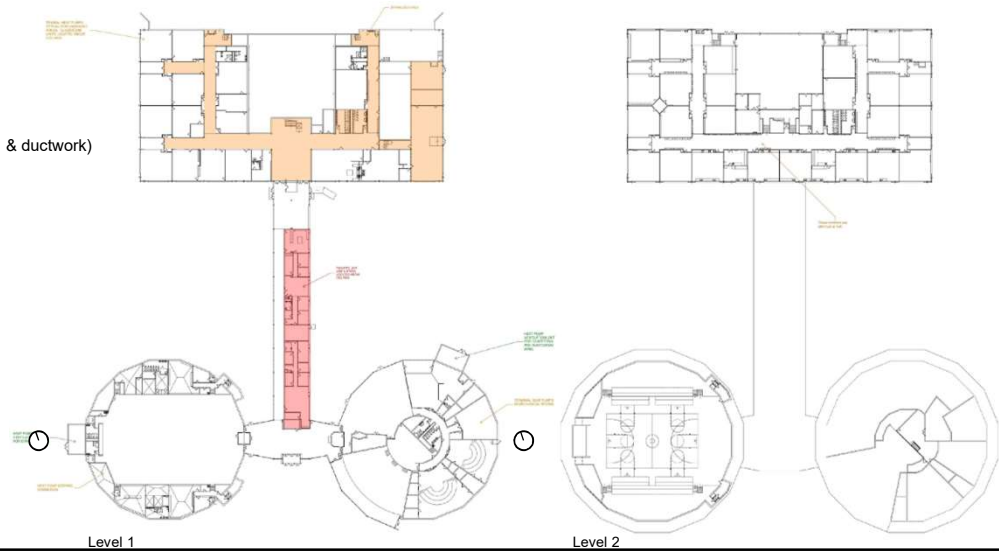

Physical Assessment

Electrical / Taft Middle School

- Lighting & Controls
- Emergency Light Systems
- Power System
- IT Network
- Cameras
- Access Control
- Paging System
- Door Entry Station
- Clocks
- Fire Alarms
- Classroom A/V System

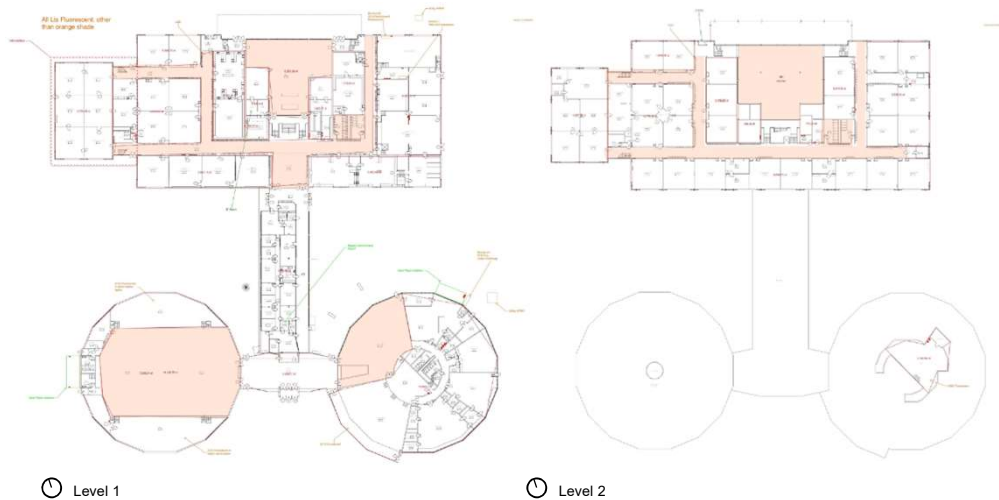

Physical Assessment

Cost / Taft Middle School

Site Improvements	\$ 676,280
Building Exterior	\$ 2,446,692
Interior Deficiencies	\$ 1,242,900
Mechanical	\$ 1,931,320
Electrical	\$ 1,532,760
Food Service	\$ 339,200
SUBTOTAL	\$ 8,169,152

HARDING MIDDLE SCHOOL

- 115,445 GSF
- 750 NSF AVG CLASSROOM



Site Deficiencies

1. Parking diagonal & longitudinal slope in excess of 2.0%
2. Compliant ramp makes longitudinal walk non-compliant
3. Walk in excess of 2.0% cross slope
4. A-H: Non-accessible exit / entrance
5. No lighting

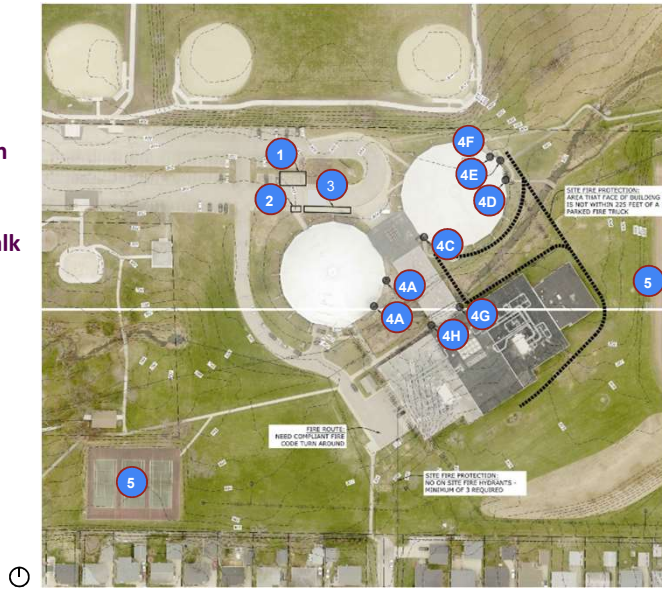

Physical Assessment

Floor / Harding Middle School

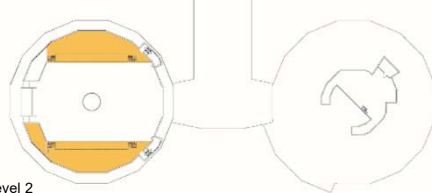
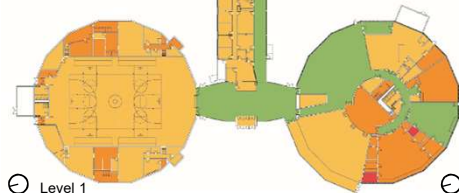

Level 1

Level 2

Casework - 26

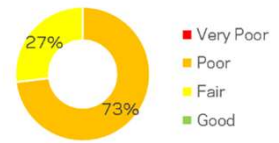

Doors

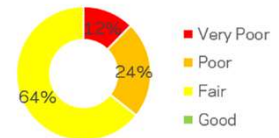

Physical Assessment

Ceiling / Harding Middle School

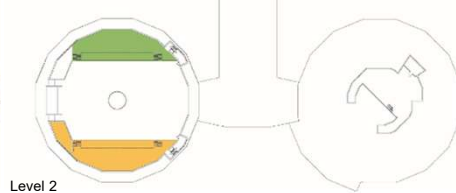
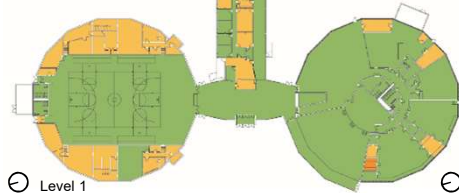

Windows

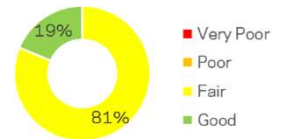

Special Equipment

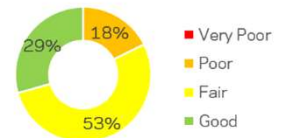

Level 1

Level 2

Physical Assessment

ADA Code Compliance / Harding Middle School

1. Non-compliant fixtures and stalls in restrooms
2. Non-ADA casework and sinks
3. Non-compliant stairs / guard rails, no handrails
4. No ADA accessible seating
5. Food Service:
 1. Serving equipment cannot maintain proper temperatures
 2. Undersized equipment
 3. Equipment beyond life expectancy

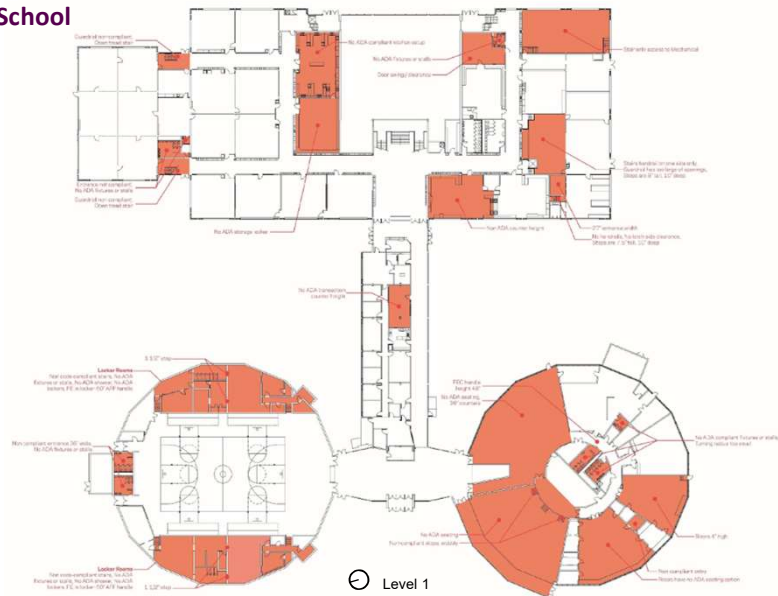

Level 1

Physical Assessment

ADA Code Compliance / Harding Middle School

1. Non-compliant fixtures and stalls in restrooms
2. Non-ADA casework and sinks
3. Non-compliant stairs / guard rails, no handrails
4. No ADA accessible seating
5. Food Service:
 1. Serving equipment cannot maintain proper temperatures
 2. Undersized equipment
 3. Equipment beyond life expectancy

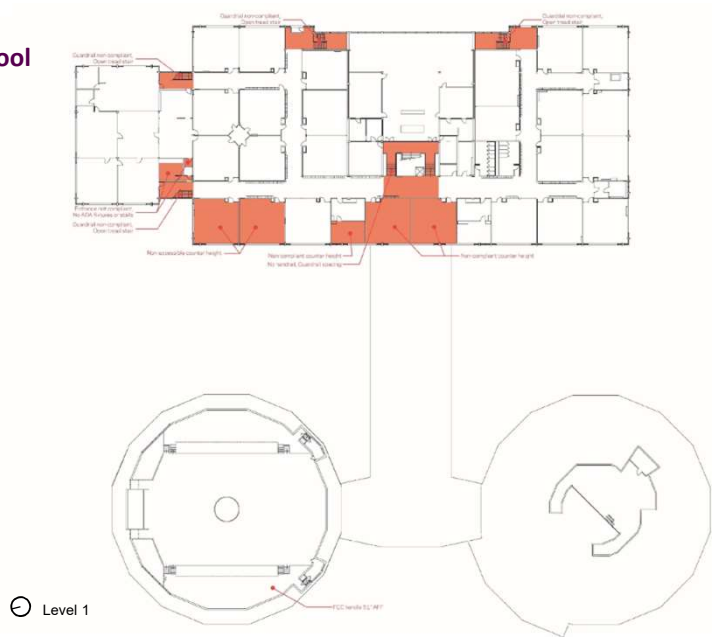

Physical Assessment

Mechanical / Harding Middle School

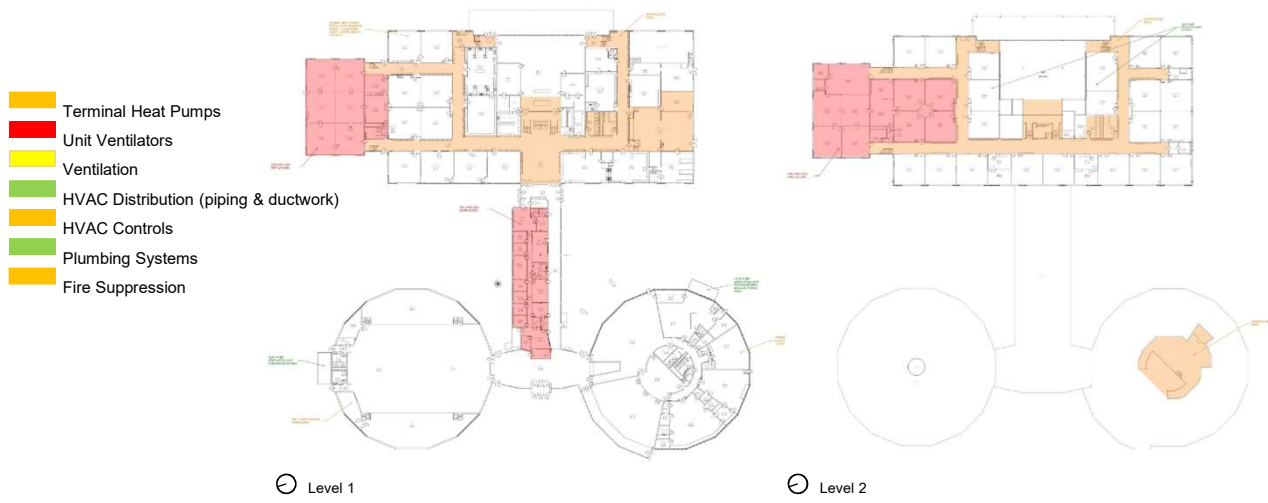

Physical Assessment

Electrical / Harding Middle School

- Lighting & Controls
- Emergency Light Systems
- Power System
- IT Network
- Cameras
- Access Control
- Paging System
- Door Entry Station
- Clocks
- Fire Alarms
- Classroom A/V System

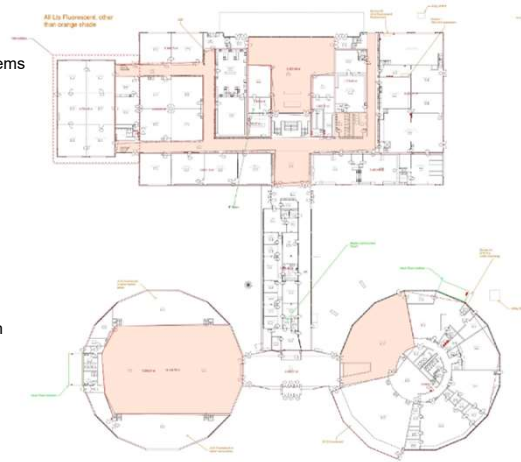

⌚ Level 1

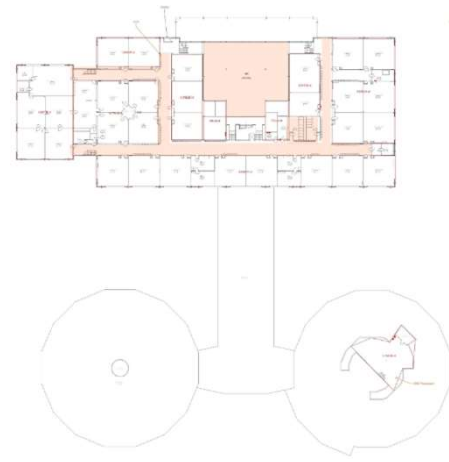

⌚ Level 2

Physical Assessment

Cost / Harding Middle School

Site Improvements	\$ 680,414
Building Exterior	\$ 2,446,692
Interior Deficiencies	\$ 1,390,770
Mechanical	\$ 1,289,600
Electrical	\$ 1,559,260
Food Service	\$ 307,400
SUBTOTAL	\$ 8,674,136

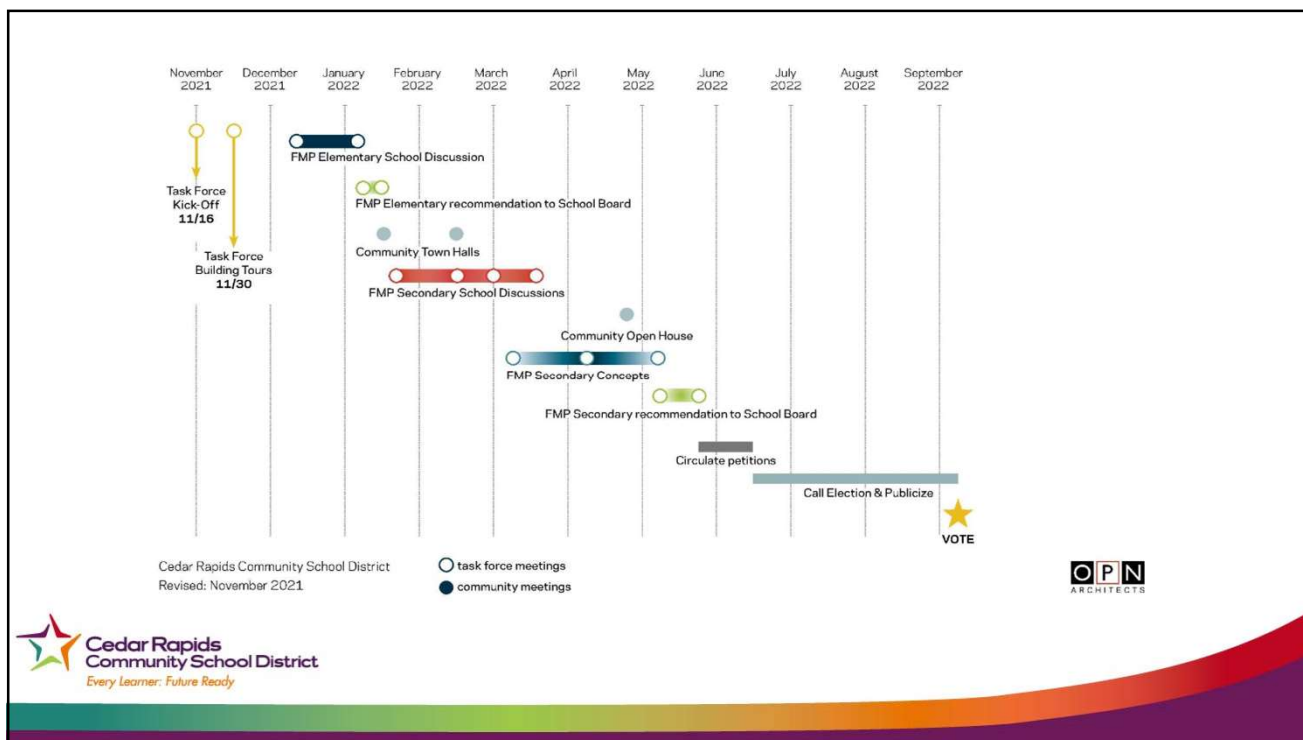

NEXT STEPS

- Next Meeting: January 27th @ 5:30 -7:30
- FMP Elementary Priorities Continued
- FMP Secondary Big Picture

Meeting Dates:

November 30
December 24
January 6
January 27
February 15
March 3
April and May TBD

Spring 2022: FMP Task Force recommendations will be taken to the BOE of Directors and will have had community input, board input, and are ready for BOE Directors to vote on those recommendations.